



1. Operating with two hands:

Place your right hand on the gimbal handle. With your left hand, take your index finger and thumb and place it on the guide ring. The pad of your index finger should be placed on the tongue of the guide ring. The pad of your thumb should be placed on the slot used to lock the gimbal in place for travel mode. With a light touch you can now pan/tilt and guide your Smoothee.

There are a few different ways you can operate your Steadicam Smoothee. Your main goal is to be comfortable with your grip and still achieve a smooth shot, or should I say a "Smoothee shot"!

How you operate can depend on the size of your hands and your skill level. We suggest you try all three methods and see which style best suits you. Enjoy!

2. Operating with one hand and just your thumb:

With your dominant hand, hold onto the gimbal handle. With the same hand, place the pad of your thumb on the slot used to lock the gimbal in place for travel mode. With a light touch of your thumb you can now pan/tilt and guide your Smoothee.



3. Operating with one hand, your index finger and your thumb:

With your dominant hand, hold onto the gimbal handle but this time, use both your index finger and thumb to grasp the guide ring gently. Again, with a light touch you can now pan/tilt and guide your Smoothee.



Please Note

These instructions are generic and are also compatible for the Apple iPhone 3GS, Apple iPhone 4, FLIP Mino 120 and certain other handheld devices.



Steadicam Smoothee™ Warranty

Tiffen warrants each Steadicam product manufactured by Tiffen to be free from defects in material and workmanship under normal conditions of use and service for a period of (6) six months for parts and six (6) months for labor from the date of purchase. Tiffen's obligation under this warranty is limited at its option to either repair or replace the defective product. If the product has been superseded, warranty replacement can be made with a current model of the same quality performing the equivalent function. This warranty does not cover cosmetic refurbishment on any Steadicam model. This warranty is expressly made in lieu of all other warranties, expressed or implied, including specifically without limiting the generality thereof, any implied warranty or merchantability, and of all other obligations or liabilities and Tiffen shall under no circumstances be liable for any consequential damages, expenses or losses or damages resulting from a defect of its product. Tiffen should be notified of a defect in the product by contacting Tiffen Steadicam Customer Service at 800-645-2522 (631-273-2500) or techsupport@tiffen.com. Tiffen will generate a Return Authorization Number for the defective item to be returned to the manufacturer's service center. The product should be sent to the Tiffen Service Center prepaid and adequately insured with a return authorization number clearly visible on the front of the package as well as in a letter describing the problem. All returns must include copy of dated sales receipt as proof of purchase. This warranty gives you specific legal rights, and you may also have other rights that vary from state to state.

Register your Smoothee™ at:

www.tiffen.com/smoothee

and get an additional (6) six months parts and labor warranty.

Check our website: www.tiffen.com for available parts & warranty extension.

TIFFEN
The Difference is Tiffen

The Tiffen Company

Phone: 631-273-2500 • 1-800-645-2522

Tiffen-Steadicam

Phone: 818-843-4600 ext. 7910 • 1-800-593-3331

Tiffen International Ltd.

Tel: (44) 870 1001220 • Fax: (44) 1869 321766 • email: info@tiffen.com

www.tiffen.com

Trademarks are the property of their respective companies.

1110

STEADICAM SMOOTHEE™

Set-Up Instructions



LIT-810000

1. Install the camera into the holder.

- See holder package for correct orientation

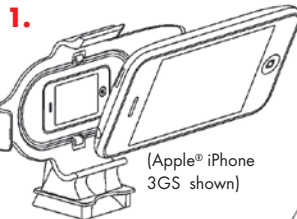

2. Install the holder into the SMOOTHIE.

- Rotate lock lever to OPEN position
- Insert holder
- Rotate lock lever to CLOSED position

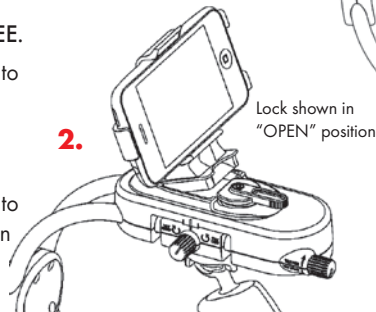

3. Adjust the SMOOTHIE until level.

- Grip SMOOTHIE by the handle only and steady the SMOOTHIE so that it does not sway

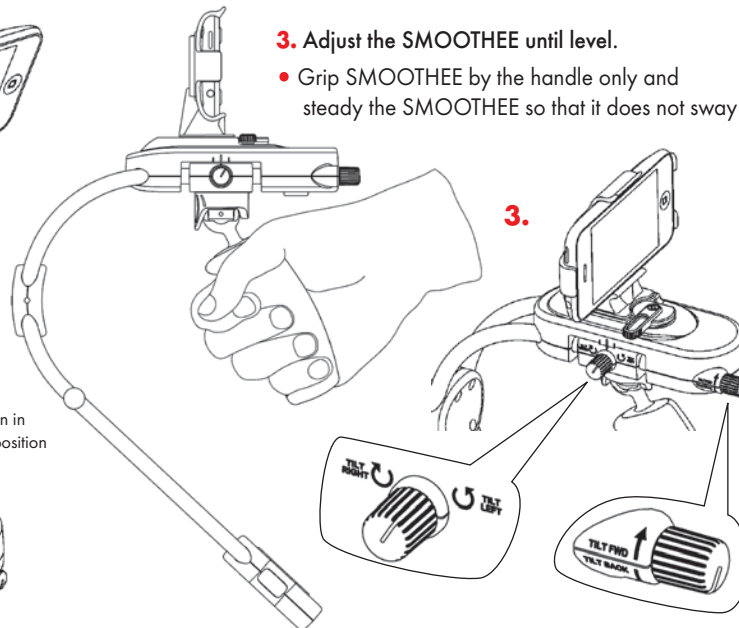

- If the camera is tilting to the front, turn the rear knob counter-clockwise ("TILT BACK" direction) until the camera is level

- If the camera is tilting to the back, turn the rear knob clockwise ("TILT FWD" direction) until the camera is level

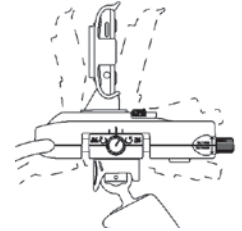

- If the camera is tilting to the right, turn the side knob counter-clockwise ("TILT LEFT" direction) until the camera is level

- If the camera is tilting to the left, turn the side knob clockwise ("TILT RIGHT" direction) until the camera is level

